

Part No. 234450

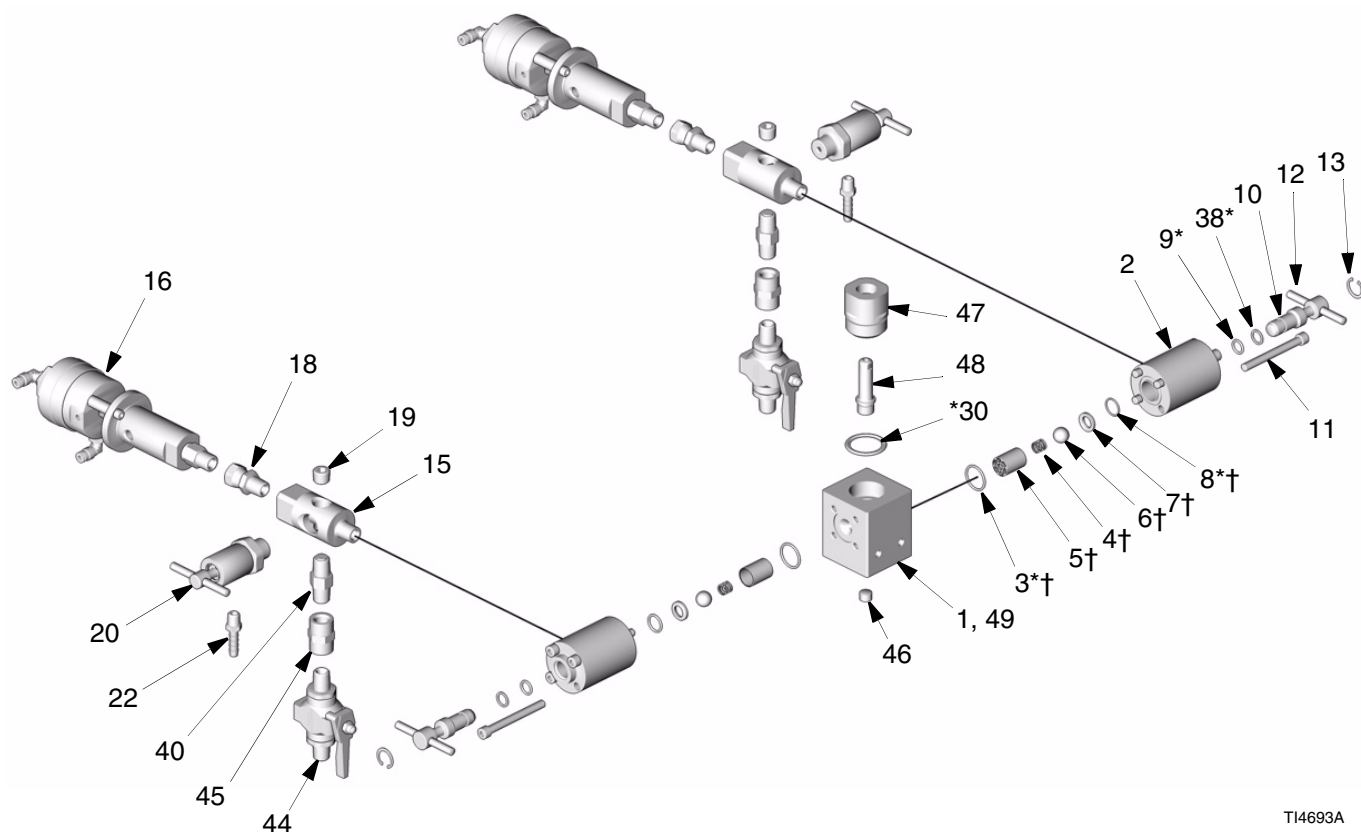

T14693A

Part No. 234450

Used with ProMix Easy™ Air-assisted Applications

Ref. No.	Part No.	Description	Qty.	Ref. No.	Part No.	Description	Qty.
1	15D239	Integrator Body	1	18	156823	Swivel Union; 1/4-18 npt	2
2	15D310	Manifold Housing	2	19	101970	Pipe Plug; 1/4-18 ptf	2
3*†	110135	O-Ring; PTFE	2	20	244683	Sampling Valve	2
4†	117558	Spring	2	22	116746	Barbed Fitting	2
5†	15D312	Ball Guide Bushing	2	30*	110966	O-Ring; PTFE	1
6†	105445	Ball; 1/2"	2	38*	119187	O-Ring; PTFE	2
7†	196832	Seat	2	40	501867	Check Valve	2
8*†	104319	O-Ring; PTFE	2	44	214037	Shutoff Valve	2
9*	111316	O-Ring; chemical resistant fluoroelastomer	2	45	113093	Pipe Connector	2
10	15D311	Valve	2	46	110208	Pipe Plug	1
11	101950	Screw; 1/4-20 UNC x 2.5"	8	47	15D414	Integrator Cover	1
12	102915	Drive Pin	2	48	15D413	Pipe	1
13	110082	Retaining Ring	2	49	C19364	Set Screw; 1/4 UNC x .75	2
15	15D336	Ratio Housing	2				
16	287222	Dispense Valve; see manual 310655	2				

* Parts included in Kit 234450 (purchase separately).

† Parts included in Kit 248430 (purchase separately).